

WALL ASSEMBLIES

Ref Wall Type 888309009 - Grade 10 foundation no insulation no finish.dwg

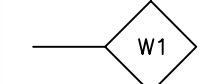

Ref Wall Type 888309009 - Grade 10 foundation no insulation no finish.dwg

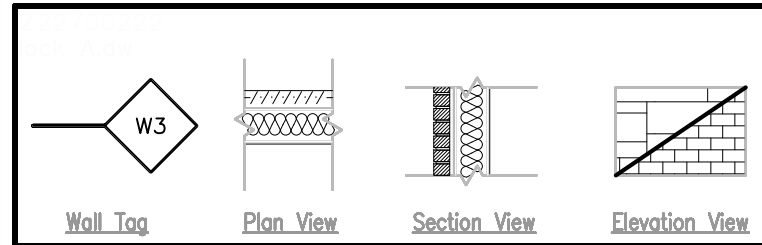
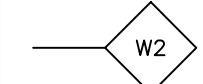

Exterior Brick or Stone Finish
 1" Air Space
 4" Sheathing with Delta Vent SA air barrier by Cosella-Dorcken Products Inc.
 2"x6" Wood studs @ 16" o/c
 Batt insulation as per SB-12
 6 mil. Vapour Barrier
 1" G.W.B. Finish (Interior side)

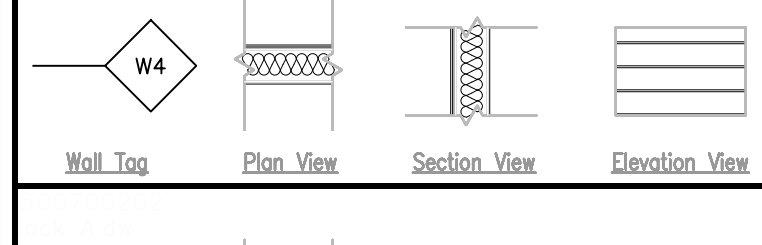

Exterior Siding Finish
 1" Strapping
 4" Sheathing with Delta Vent SA air barrier by Cosella-Dorcken Products Inc.
 2"x6" Wood studs @ 16" o/c
 No FRR is required or proposed
 Batt insulation as per SB-12
 6 mil. Vapour Barrier
 1" G.W.B. Finish (Interior side)
 1" G.W.B. Finish (Exterior side)

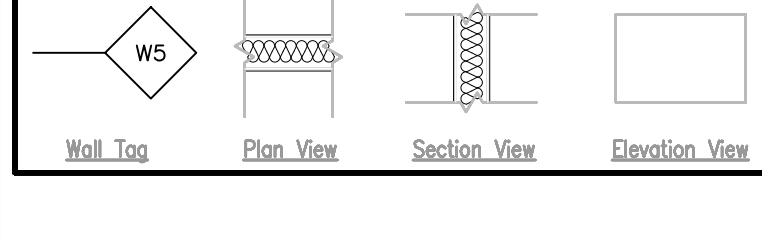

2"x6" Wood studs @ 16" o/c
 Batt insulation as per SB-12
 1" G.W.B. Finish (Interior side)

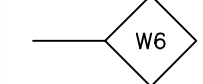

Ref Wall Type 500800002 - 2x4 interior partition.dwg

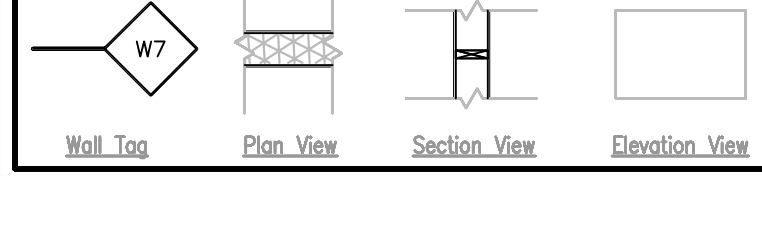

1" G.W.B. Finish (Exterior side) (TALL WALL)
 2"x6" Wood studs @ 12" o/c - 2"x6" Md Girts @ 48" o/c
 1" G.W.B. Finish (Interior side)

FLOOR ASSEMBLIES

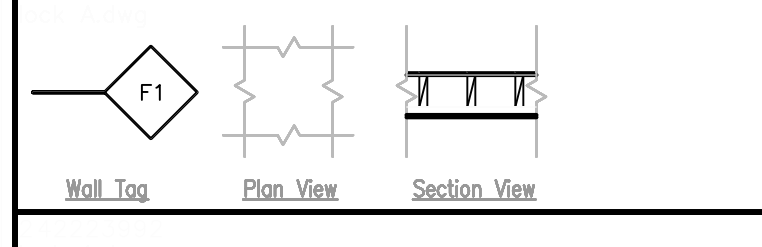

Floor finish as per plan (see finish spec or owners notes).
 5/8" tongue & groove sub floor.
 Floor joists to plan (see plan for direction and size).
 Bridging/Strapping/Clued/Screwed and/or IBS as per plan
 No insulation required or specified
 No vapor barrier/air barrier required or specified
 No sound barrier required or specified
 No fire resistance rating required or specified
 1/2" G.W.B. - 9.29.5.2. Typical ceiling finish material: 1/2" ASTM C1395 / C1395M

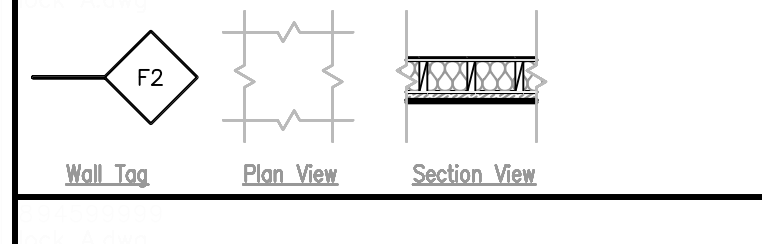

Floor finish as per plan (see finish spec or owners notes).
 5/8" tongue & groove sub floor.
 Floor joists to plan (see plan for direction and size).
 Bridging/Strapping/Clued/Screwed and/or IBS as per plan
 Batt insulation as per SB-12 requirements
 2" ridged insulation below all joist as a thermal break and air/vapour barrier
 No insulation required or specified
 No vapor barrier/air barrier required or specified
 No sound barrier required or specified
 No fire resistance rating required or specified
 1/2" G.W.B. - 9.29.5.2. Typical ceiling finish material: 1/2" ASTM C1395 / C1395M

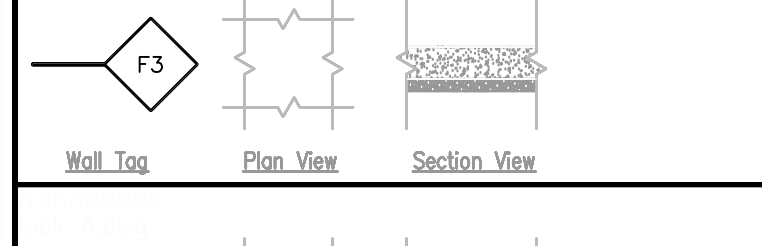

Finished surface to be troweled smooth & even
 No subfloor required or specified
 3" Interior concrete slab 25 MPa
 3" Clear Gravel Fill (Non Structural Span)
 No insulation required or specified
 No vapor barrier/air barrier required or specified
 No sound barrier required or specified
 No fire resistance rating required or specified
 No ceiling finish required or specified

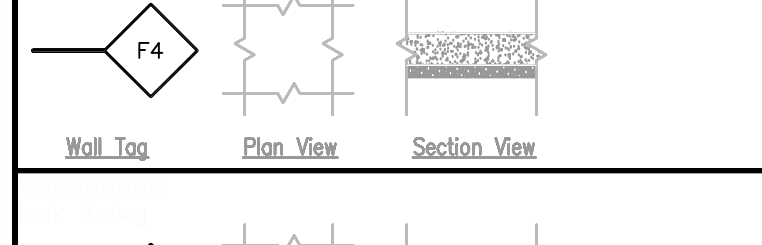

Finished surface to be troweled smooth & even
 No subfloor required or specified
 4" Exterior Concrete Slab 32 MPa
 5" Clear Gravel Fill (Non Structural Span)
 No insulation required or specified
 No vapor barrier/air barrier required or specified
 No sound barrier required or specified
 No fire resistance rating required or specified
 No ceiling finish required or specified

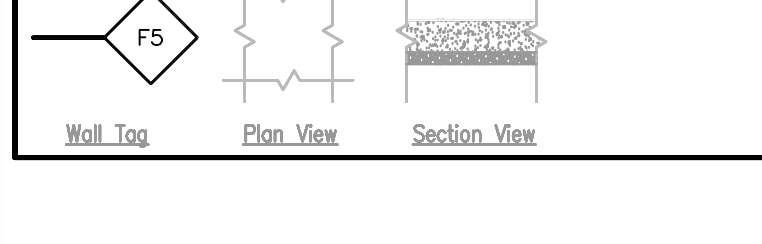

Finished surface to be troweled smooth & even
 No subfloor required or specified
 6" Exterior Concrete Slab 32 MPa
 5" Clear Gravel Fill (Non Structural Span)
 No insulation required or specified
 No vapor barrier/air barrier required or specified
 No sound barrier required or specified
 No fire resistance rating required or specified
 No ceiling finish required or specified

CEILING & ROOF ASSEMBLIES

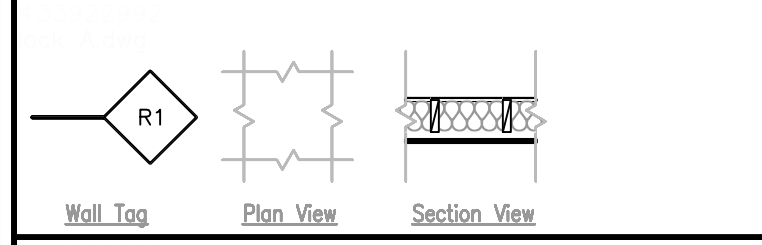

Typical Roof finish 20 year asphalt shingles as per OBC 9.26.0.0
 1/2" sheathing with H-clips & Delta roof underlay
 Roof structure to plan (see plan for direction and size).
 No additional structure required or specified
 Batt insulation as per SB-12 requirements
 6 mil. air and vapor barrier
 No sound barrier required or specified
 No fire resistance rating required or specified
 1/2" G.W.B. - 9.29.5.2. Typical ceiling finish material: 1/2" ASTM C1395 / C1395M

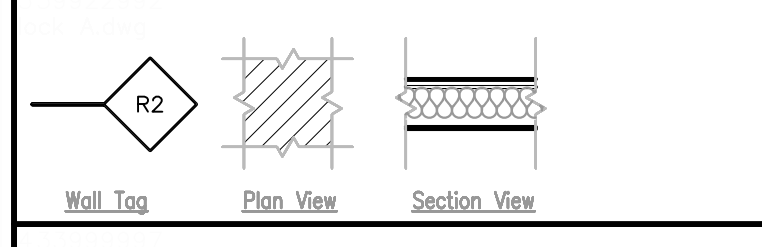

Flat Roof Finish (2 Ply Torch Down or PVC or EPDM membrane)
 1/2" sheathing with H-clips & Delta roof underlay
 No structure required or specified
 No additional structure required or specified
 Batt insulation as per SB-12 requirements
 6 mil. air and vapor barrier
 No sound barrier required or specified
 No fire resistance rating required or specified
 1/2" G.W.B. - 9.29.5.2. Typical ceiling finish material: 1/2" ASTM C1395 / C1395M

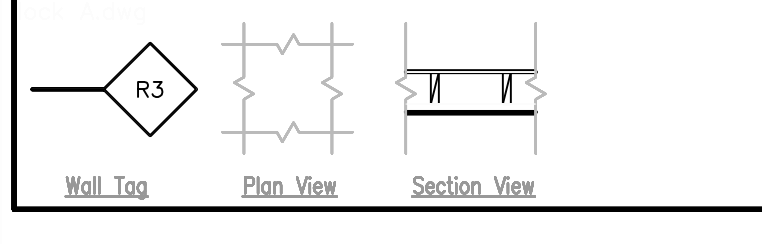

Typical Roof finish 20 year asphalt shingles as per OBC 9.26.0.0
 1/2" sheathing with H-clips & Delta roof underlay
 Roof structure to plan (see plan for direction and size).
 No additional structure required or specified
 No insulation required or specified
 No vapor barrier/air barrier required or specified
 No sound barrier required or specified
 No fire resistance rating required or specified
 Alum soffit finish or painted plywood

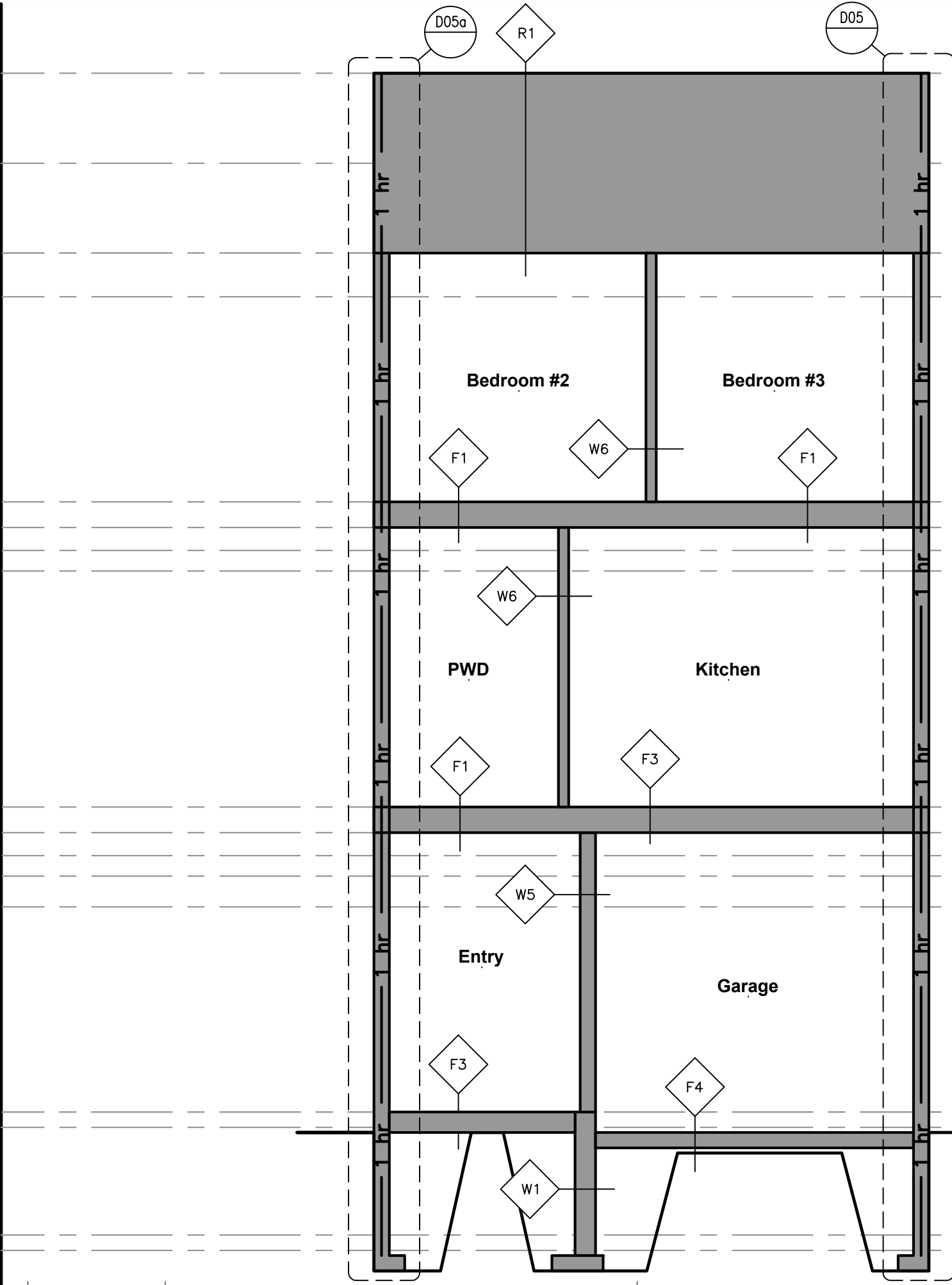
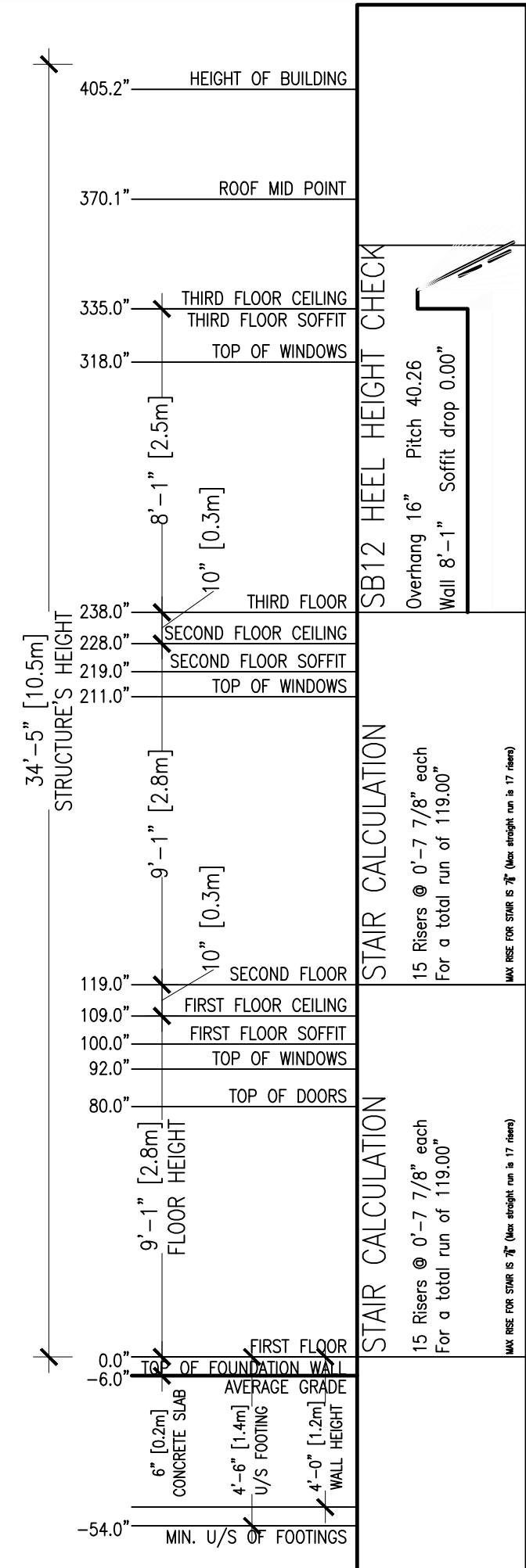

A Section 2
VO1 SCALE 1/4" = 1'-0"

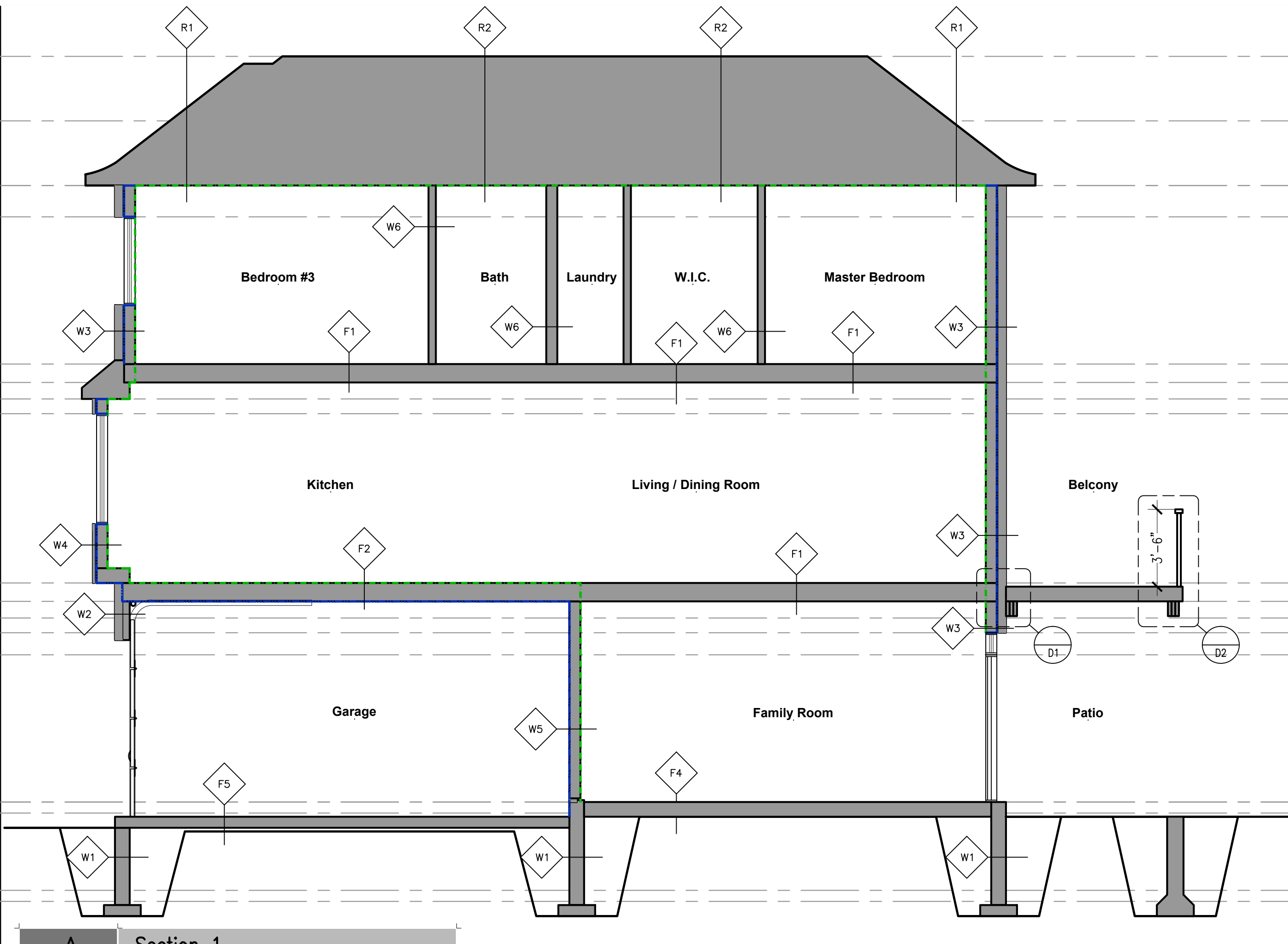
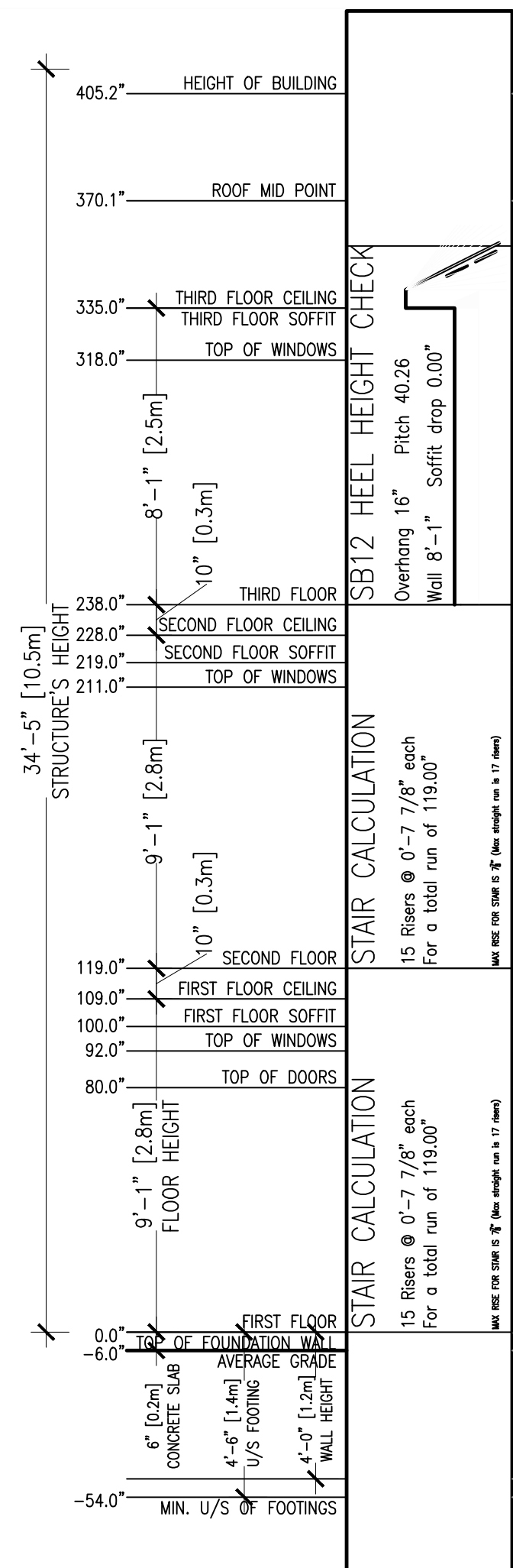

A Section 1
VO1 SCALE 1/4" = 1'-0"

FILE NO. DA-16-175 111 WILSON STREET EAST, ANCASTER ONTARIO

VIRTUAL CREATIONS INC. 28844

(905) 481 1153 BCIN NO.

PROJECT 16/2016/054 SHEET W05 TOTAL NO.04 PROJECT 16/2016/054 SHEET W05 TOTAL NO.04

ISSUED Nov 10 2017

Classification: Original Signature: **WWW.VCINC.CA**

AT VIRTUAL CREATIONS INC. THE BEST EFFORT HAS BEEN MADE TO RECORD EXISTING BUILDING STRUCTURES AND PROPOSED A COMPREHENSIVE SET OF CONSTRUCTION DRAWINGS. HOWEVER, THERE ARE AREAS AT THE TIME OF DESIGNING THAT ARE UNAVAILABLE OR INACCESSIBLE. WITH PROPER COORDINATION WITH A BUILDER / CONTRACTOR THESE ISSUES CAN BE PRIOR TO FABRICATION. DETERMINE LOCATIONS OF EXISTING SERVICES. INFORM VIRTUAL CREATIONS INC. OF ANY CHANGES, DISCREPANCIES OR SUBSTITUTIONS FOR REVIEW BEFORE COMMENCING CONSTRUCTION. ALL DESIGNS AND DRAWINGS ARE THE SOLE PROPERTY AND COPYRIGHT OF VIRTUAL CREATIONS INC. ANY REPRODUCTIONS MUST BE AUTHORIZED BY VIRTUAL CREATIONS INC. OR PURCHASED THROUGH VIRTUAL CREATIONS INC. DIRECTLY.

